

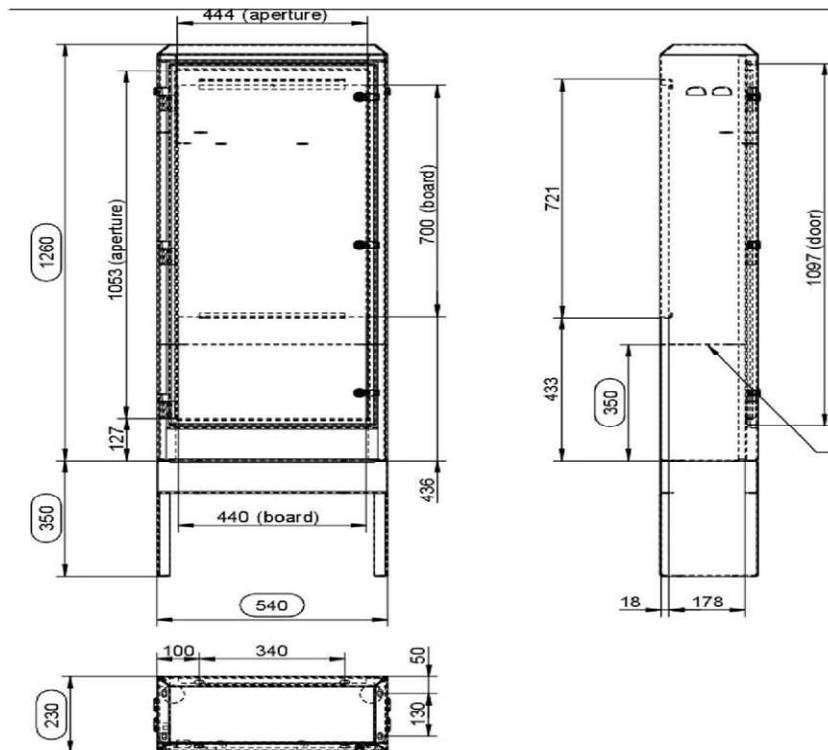

## Network-Service Pillars

**ESB Three phase 1 door metered pillar- 540W x 230D x 1200H**  
 (additional plinth height 350mm if required)



**Code: 9003**

### Specification:

- Designed to IP44
- Mounting Area 700 x 450
- Material - manufactured from 3mm mild Steel
- Finish - hot dipped galvanised to BS EN ISO 1460
- Base - Sealed with Bituminised coating
- Backboard - 18mm Flame retardant grade plywood treated with water repellent
- Fitted with 8mm Triangular ¼ turn locks x 3
- Compressed rubber gasket on door
- Gland Plate partition 350mm from ground level
- Earth Stud fitted as standard with earth strap & bolt, nuts & washers on both body & door

### Options Available:

- Back board grade-Marine Plywood
- Louvre panels
- Non standard sizes to customer specification
- Painted to Customer RAL number